

Clerks Note: The map shading for the subject property Mohebbi has been corrected to reflect the property being approved for S-3.

Resolution No.:	19-1426
Introduced:	February 8, 2022
Adopted:	October 25, 2022

**COUNTY COUNCIL
FOR MONTGOMERY COUNTY, MARYLAND**

Lead Sponsor: County Council

SUBJECT: Amendment to the Comprehensive Water Supply and Sewerage Systems Plan

Background

1. Section 9-501 et seq. of the Environmental Article of the Maryland Code requires the governing body of each County to adopt and submit to the State Department of the Environment a comprehensive County Plan, and from time to time amend or revise that Plan for the provision of adequate water supply systems and sewerage systems throughout the County.
2. Section 9-507 of the Environmental Article of the Maryland Code provides that the Maryland Department of the Environment (MDE) has 60 days to review a county governing body's action to amend the County's Water and Sewer Plan. Upon notice to the County, MDE may extend that review period for another 45 days, if necessary. At the conclusion of this review, MDE must either approve or reject the Council's action on each of these amendments, or the action is confirmed by default. Any action approved or taken by this resolution is not final until that action is approved by MDE or the period for final MDE action has expired.
3. In accordance with the State law on December 30, 1969, by Resolution No. 6-2563, the County Council adopted a Comprehensive Ten-Year Water Supply and Sewerage Systems Plan which was approved by the State Department of the Environment.
4. The County Council has from time to time amended the Plan.
5. On January 27, 2022, the County Council received a recommendation from the County Executive regarding Water and Sewer Plan amendment: WSCCR 21-TRV-03A: David Mohebbi.
6. Recommendations on this amendment were solicited from the Maryland-National Capital Park and Planning Commission, Washington Suburban Sanitary Commission Staff, and affected municipalities.

7. A public hearing was held on April 19, 2022
8. The County Council's Transportation and Environment Committee held worksessions on the request on September 12, 2022 and October 17, 2022.

Action

The County Council for Montgomery County, Maryland approves the following actions on amendments to the Ten-Year Comprehensive Water Supply and Sewerage Systems Plan as shown in the attachments to this resolution.

This is an accurate account of the meeting:

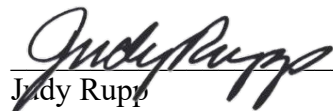
A handwritten signature in black ink, appearing to read "Judy Rupp", is written over a horizontal line.

Judy Rupp
Clerk of the Council

Montgomery County Comprehensive Water Supply and Sewerage Systems Plan January 2022 Amendment Transmittal: Water/Sewer Category Map Amendments

Montgomery County uses water and sewer service area categories, in part, to identify those properties that should use public water and/or sewer service versus those that should use onsite systems, usually wells and/or septic systems. Categories W-1 and S-1 identify properties approved for public service and that have access to public system mains. Categories W-3 and S-3 identify properties approved for public service but need new main extensions in order to receive public service. Categories W-4 and S-4, and W-4 and S-5 identify properties that currently should use onsite systems but are proposed for public service in the future. Categories W-6 and S-6 identify properties that should use on-site systems, where public service is not planned for at least the next ten years. (See page 5 for additional information.)

Property owners file category change map amendment requests seeking to change the service areas for their property from one category to another, often based on anticipated development plans. The following charts present the County Council's actions on a water/sewer category map amendment request filed with DEP and transmitted by the County Executive to the Council for consideration on January 27, 2022.

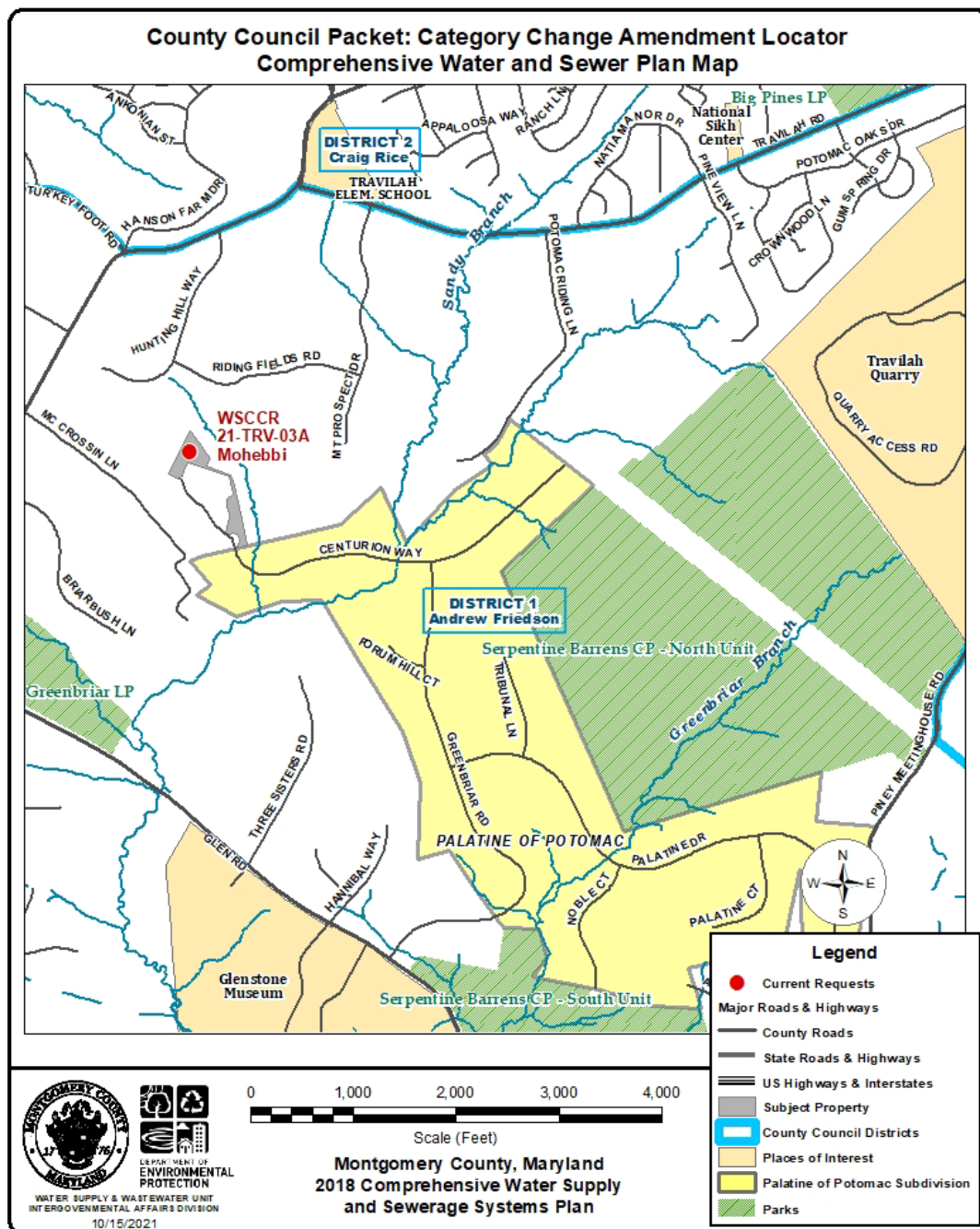

The Maryland Dept. of the Environment (MDE) must review and concur with this approval action. Applicants receiving a category change approval in this resolution may proceed with WSSC Water main extension requests prior to MDE's action but do so at their own risk.

**Montgomery County Comprehensive Water Supply and Sewerage Systems Plan
January 2022 Amendment Transmittal: Water/Sewer Category Map Amendments**

WSSCR 21-TRV-03A: David Mohebbi

Property Information and Location Property Development	Applicant's Request: Service Area Categories & Justification								
<ul style="list-style-type: none">• 11905 Centurion Way, Potomac• Lot 3, Parcel N188, Sutton's Addition to Palatine (acct. no. 03639933)• Map tile: WSSC – 217NW12; MD –ER51• East side of Centurion Way, 2,050 feet from the intersection with Greenbriar Rd.• RE-2 Zone; 5.17 ac.• Travilah Planning Area Potomac Subregion Master Plan (2002)• Watts Branch Watershed (MDE Use I)• <u>Existing use</u>: Single-family home <u>Proposed use</u>: Single-family home to remain	<table><tr><th colspan="2"><u>Existing – Requested – Service Area Categories</u></th></tr><tr><td>W-1</td><td>W-1 (no change)</td></tr><tr><td>S-6*</td><td>S-3</td></tr><tr><td colspan="2">*Consideration of the request for category S-3 was tabled.</td></tr></table> <p><u>County Council Action</u></p> <p>Approve S-3, for one sewer connection only, as a public health concern. The needed low-pressure sewer extension will be the shorter of the two extension options evaluated by WSSC Water, approximately 70 feet in length. The new sewer main will not extend beyond the existing public road right-of-way (Centurion Way cul-de-sac).</p> <p><i>Note: Request for category S-3 previously tabled by the T&E Committee on 9/12/2022.</i></p>	<u>Existing – Requested – Service Area Categories</u>		W-1	W-1 (no change)	S-6*	S-3	*Consideration of the request for category S-3 was tabled.	
<u>Existing – Requested – Service Area Categories</u>									
W-1	W-1 (no change)								
S-6*	S-3								
*Consideration of the request for category S-3 was tabled.									

Water & Sewer Service Area Categories Summary

Category Definition and General Description	Category Definition and General Description
<p>W-1 and S-1</p> <p>Properties approved for and generally with existing access to community (public) service. This may include properties which have not yet connected to existing community service.</p>	<p>W-5 and S-5</p> <p>Properties planned for future public service, but which may use private, on-site systems (wells and septic systems) on a permanent basis. • Areas where improvements to or construction of new community systems are planned for the seven- through ten-year period.</p>
<p>W-3 and S-3</p> <p>Properties planned and approved for community (public) service, but <u>without</u> existing access to public service. • Public service will generally be provided within two years as development and requests for community service are planned and scheduled.</p>	<p>W-6 and S-6</p> <p>Properties that will use private, on-site systems (wells and septic systems), where community (public) service is not planned. • Category 6 includes areas that are planned or staged for community service beyond the scope of the plan's ten-year planning period, and areas that are not ever expected for community service on the basis of adopted plans.</p>
<p>W-4 and S-4</p> <p>Properties planned for future public service, but which need to use private, on-site systems (wells and septic systems) in the interim. • Areas where improvements to or construction of new community systems will be programmed for the three- through six-year period. B</p>	<p>Note: Although the majority of properties in the county have the same water category as sewer category (i.e. W-3 and S-3, or W-5 and S-5), this is not always the case. The County does not always assign water and sewer categories in tandem, due to differences in service policies or to actual service availability. For example, a particular property could have service area categories W-1 and S-6. Therefore, it is important to know both the water <i>and</i> sewer service area categories for a property. Montgomery County does not use categories W-2 and S-2 in its Plan.</p>

R:\Programs\Water_and_Sewer\actions-COUNCIL\packets\2021-oct-fy21-q34\council\full council\resolution\cr-attachment-A-draft-2022-1018.docx

The Maryland Dept. of the Environment (MDE) must review and concur with this approval action. Applicants receiving a category change approval in this resolution may proceed with WSSC Water main extension requests prior to MDE's action but do so at their own risk.

Montgomery County Comprehensive Water Supply and Sewerage Systems Plan
January 2022 Amendment Transmittal: Water/Sewer Category Map Amendments

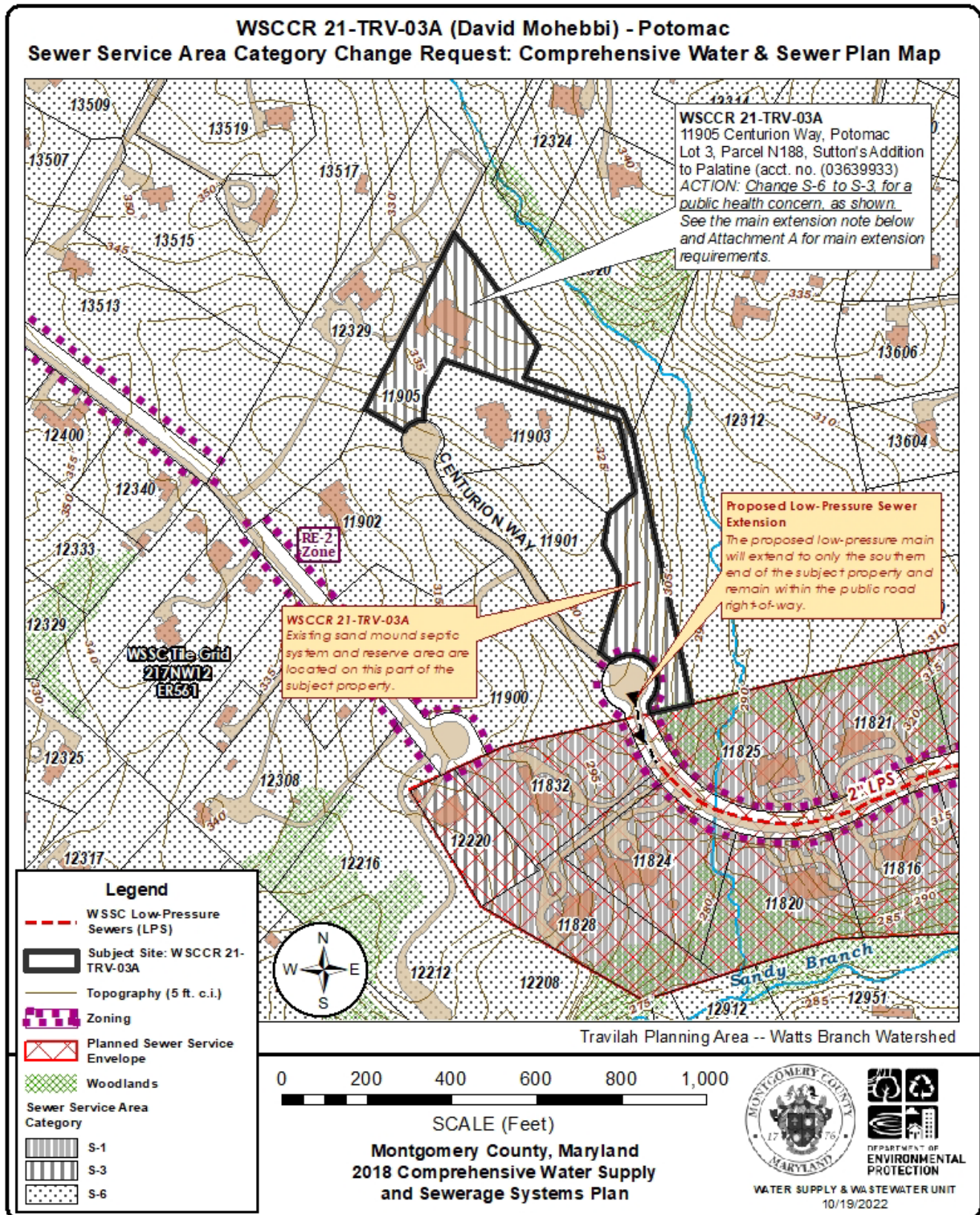

The Maryland Dept. of the Environment (MDE) must review and concur with this approval action. Applicants receiving a category change approval in this resolution may proceed with WSSC Water main extension requests prior to MDE's action but do so at their own risk.